



## SPECIFICATION SHEET

Description

25/28kV Class 200 Amp Long Shank Bushing Well with Bail Tabs

Product Series

**BWLT**

**BWLT : with permanent stud**

**BWLTR : with replaceable stud**

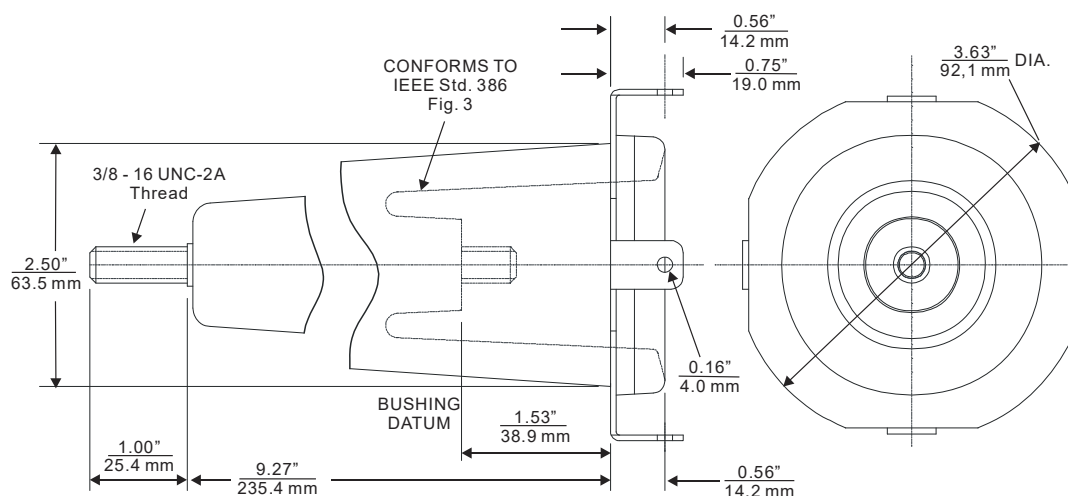

### Application:

CableMate BWLT series bushing wells are designed for the termination of primary winding leads of oil-filled and SF6 insulated apparatus including single and three-phase pad-mounted transformers, vault-type transformers, submersible transformers and switchgear rated up to 16.2/28 kV at 200 amps and will universally accept all loadbreak and deadbreak bushing inserts that conform to IEEE 386 standard Figure 3.

### Design:

CableMate BWLT bushing wells have a shank length of 9.25" (235 mm) for top-mount installations. They are molded of epoxy with a stainless-steel flange for welding to the apparatus. A conductive rubber shield at the mating surface with connecting devices provides a fully-shielded, cable-to-apparatus connection. Four (4) tabs are provided to accept hold down bails from various types of cable connectors. A removable stud option is available for easy field replacement of the bushing stud in the event of damage or breakage by specifying "R" at the end of catalog number.

### Ratings

Description	Rating
Standard Voltage Class	25/28 kV
Maximum Rated Voltage Phase-to-Phase	28 kV
Maximum Operating Voltage Phase-to-Ground	16.2 kV
BIL and Full Wave Crest (1.2 x 50 $\mu$ s wave)	125 kV
60Hz AC One Minute Withstand (rms)	60 kV
DC 15 Minute Withstand	78 kV
AC Corona Extinction @ 3p.C.sensitivity	25.8 kV
Continuous Current (rms)	200 A
Short Time Current Rating at 0.17 s (rms)	12.5kA sym

### Ordering Instruction:

To order 25kV long shank bushing well with bail tabs, specify: **BWLT**

To order 25kV long shank bushing well with bail tabs and replaceable stud, specify: **BWLTR**